

Introducing  **ENGAGE™**
TECHNOLOGY

Smart security for the open-minded

A re-imagined connectivity platform from Allegion



Taking the cost and complexity out of access control gives you the freedom to be more open-minded about security.



Introducing ENGAGE technology, now available with the new Schlage® NDE Wireless Lock

 **ENGAGE**[™]
TECHNOLOGY



Easy to install

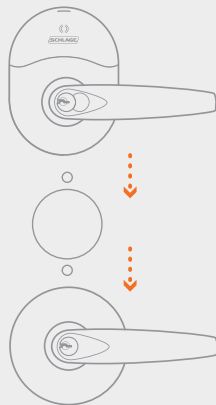

ENGAGE™ technology makes it easy

ENGAGE technology is a connectivity platform that simplifies the ability to connect people, openings and access management to deliver cost effective intelligence and efficiency to your space.

New Schlage wireless locks with ENGAGE technology are designed to fit into a standard mechanical ND door prep. Installation is complete in minutes with a Phillips screwdriver, with no additional holes to drill or wires to run to the opening. Additionally, lever handing is field reversible in seconds, so there is no need to worry if it is a left or right-handed door.

ENGAGE cloud based web and mobile apps make it simple to configure lock settings, add users and view audits and alerts from anywhere. For advanced capabilities, Schlage wireless locks can be managed with software from one of our access control alliance partners. Schlage wireless locks can be updated manually at the lock, daily over Wi-Fi¹ or in real-time when connected to an ENGAGE gateway.²

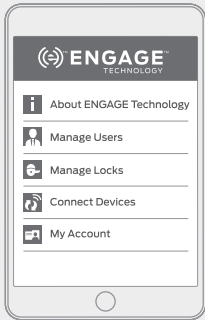

Easy to manage



Easy to use

Flexible Solutions

Wireless locks can be connected in multiple ways to fit any size budget or business.

- 1 Manually
- 2 Daily¹
- 3 Real-Time



Credential management drives efficiency

ENGAGE technology can provide tenants the freedom and flexibility to use their building ID inside their office suite. Electronic credentials, which are easily issued on cards or smart phones, reduce the need for service calls related to lockouts and re-keying. Access privileges can be quickly assigned and revoked electronically by the office administrator, making them ideal for employees, contract workers, visitors, and service providers.

Innovation improves your bottom line

ENGAGE technology enables the transition from mechanical to electronic access at a fraction of the cost of traditional wired solutions. The Schlage wireless and mechanical locks have identical door preps so they can be easily interchanged without having to replace the door or the frame. Solutions featuring ENGAGE technology can be customized to fit any size business or budget, and can be scaled to accommodate growth and expansion as needs change.

AllegionEngage.com

¹ Daily updates will occur within 24 hours as scheduled by the host
² Requires access control software from one of our Alliance Partners

About Allegion

Allegion (NYSE: ALLE) creates peace of mind by pioneering safety and security. As a \$2 billion provider of security solutions for homes and businesses, Allegion employs more than 8,000 people and sells products in more than 120 countries across the world. Allegion comprises more than 25 global brands, including strategic brands CISA®, Interflex®, LCN®, Schlage® and Von Duprin®.

For more, visit www.allegion.com

aptiQ ■ LCN ■ **SCHLAGE** ■ STEELCRAFT ■ VON DUPRIN